

### TRAFFIC MANAGEMENT SET UP/ ALLOWABLE WORKING HOURS

7AM TO 7PM, MON TO SAT  
(TM SETUP 24/7)

#### LEGEND

- WORK AREA
- CONCRETE POURING ZONE /  
FUTURE UNDERGROUND UTILITY WORKS
- 1.8M HIGH CONTAINMENT  
FENCE
- CONSTRUCTION ACCESS GATES
- CONSTRUCTION ACCESS
- CLOSE CONE WHERE SHOWN
- SITE ACCESS/CROSSOVERS
- SITE AMENITIES
- LAYDOWN AREA
- PEDESTRIAN DETOUR
- ALT PEDESTRIAN DETOUR
- CLOSE CONE WHERE SHOWN (AFTERCARE)

#### LEGEND — WORKS BY OTHERS GEORGIU

- PEDESTRIAN SIGNS
- WORK ZONE
- PEDESTRIAN DETOUR

AFTERCARE:  
AFTER HOURS OR WHEN  
NO WORKERS ON SITE

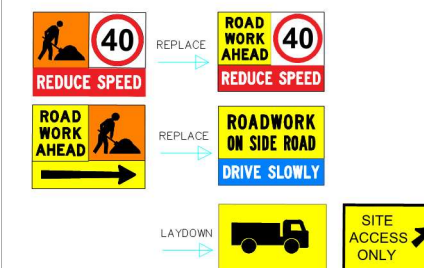

SLED-LO-RO  
END TERMINAL

LO-RO MASH BARRIER  
WITH FENCE (NOT  
A ROAD SAFETY BARRIER  
SYSTEM) OFF SET 200MM  
NORTH OF CENTRE LINE

SPOTTER — TO ASSIST  
TRUCKS EXITING  
SITE AREA

#### NOTES

1. TRAFFIC CONTROLLERS ACT AS SPOTTER TO WORKERS ON FOOT AND THAT HAVE THEIR BACKS TO THE DIRECTION OF THE TRAFFIC.
2. THE LOCATION OF THE SIGNS SHOWN ON THIS PLAN MAY BE VARIED SLIGHTLY DURING IMPLEMENTATION TO IMPROVE VISIBILITY AND EFFECTIVENESS AS PER SECTION 4.2.6 OF THE MAIN ROADS WA CODE OF PRACTICE. ANY CHANGES TO BE DOCUMENTED IN THE DAILY DAIRY.
3. ANY EXCAVATIONS DEEPER THAN 500mm TO HAVE A CLEARANCE TO TRAFFIC OF 2.5m MINIMUM.
4. REFER TO TGS004 FOR DETOURS.
5. ON CLAREMONT SHOWGROUND MAJOR EVENTS REMOVE DETOURS, SETUP TGS005 ONLY IN PLACE.